

Product End of Life Instructions

M172 Perf. Disp. 42 I/Os, Eth 2 MB 2 SSR

Modicon M172 logic controllers





Potential disassembly risks

⚠ WARNING

HAZARD OF ARC FLASH OR FIRE

- Disconnect battery terminals before disassembly
- Avoid any electrical connection between the terminals

Failure to follow these instructions can result in death or serious injury.



End of Life Instructions

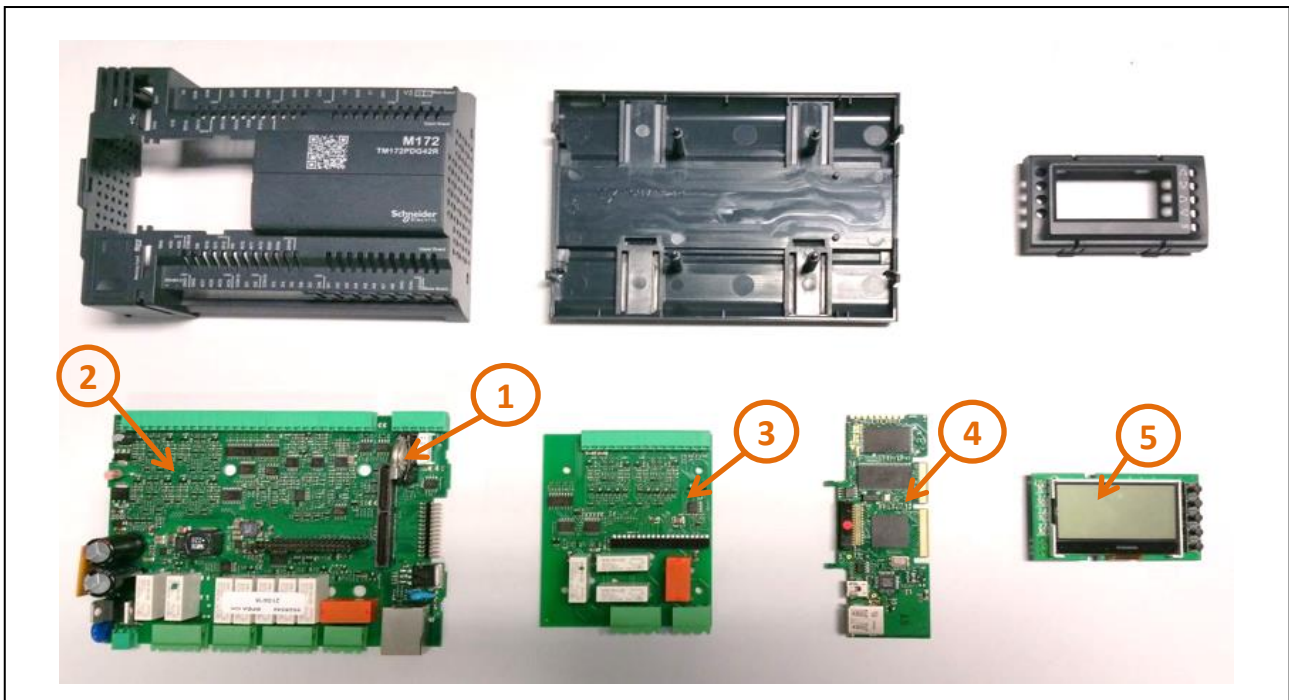

Recommendation	Number on drawing	Component / Material	Weight (in g)	Comment
To be depolluted	1	Other battery	2,6	Lithium battery
To be depolluted	2	Electronic Board (Power) > 10cm ²	131,8	PCBA
To be depolluted	3	Electronic Board (Communication) > 10cm ²	46,2	PCBA
To be depolluted	4	Electronic Board (Communication) > 10cm ²	22	PCBA
To be depolluted	5	Electronic Board (Communication) > 10cm ²	25,2	PCBA + LCD Display
Other		Top Case & Bottom Case	122,7	Plastic Parts



Product description

Manufacturer identification	Schneider Electric Industries SAS
Brand name	Schneider Electric
Product function	TM172PDG42S is a Schneider Electric's programmable controller with a built-in graphical user display, part of the range Modicon M171/M172, suitable for managing a wide range of HVAC, pumping and many other applications, from the simplex to the most complex. The reference is available as 8 DIN rail-mounted version, which saves time in terms of wiring. The 8 DIN format provides extra flexibility and easy installation.
Product reference	TM172PDG42S
Additional similar product references	TM172PDG42S TM172PBG28R TM172PBG42R TM172PDG28S TM172PDG28R TM172PDG42R TM172E12R TM172E28R EVE1020000500 EVE6000000500 TM172PBG28RI TM172PDG28RI TM172PDG28SI TM172PBG42RI TM172PDG42RI TM172PDG42SI TM172OBM28R TM172ODM28R TM172OBM42R TM172ODM42R AVC840006I500 AVD840006I500 AVD84SS06I500 AVC126006I500 AVD126006I500 AVD126S06I500 AVD126005I500 TM172PBG42RIC01 AVD126006I501 AVD126006I502 AVD126006I503 AVD840006I501
Total representative product mass	350,5 g
Representative product dimensions	110mm x 144mm x 60mm
Accessories	No
Date of information release	09-2025



Additional information

Legal information	This product family is in the scope of European Union directive 2012/19/EU on Waste Electrical and Electronic Equipment (WEEE). The product family must be disposed according to the legislation of the country. This document is intended for use by end of life recyclers or treatment facilities. It provides the basic information to assure an appropriate end of life treatment for the components and materials of the product.
In case of special transportation: transportation method	No
Recyclability potential	0% The recyclability rate was calculated from the recycling rates of each material making up the product based on REEECY'LAB tool developed by Ecosystem, for components/materials not covered by the tool, data from the EIME database and the related PSR was taken. If no data was found a conservative assumption was used (0% recyclability).

Schneider Electric Industries SAS

Country Customer Care Center
<http://www.se.com/contact>

35, rue Joseph Monier

CS 30323

F- 92500 Rueil Malmaison Cedex

RCS Nanterre 954 503 439

Capital social 928 298 512 €

www.se.com

ENVEOLI1709014_V2

Published by Schneider Electric

© 2023 - Schneider Electric – All rights reserved

09-2025